



**Power Supply System  
Aspiro 1U - MS22  
Instruction Manual**



**[www.unipowerco.com](http://www.unipowerco.com)**

**Document Number: ASPIRO1U\_MS22-3**  
aspiro1u\_ms22-man-rev3-0516.indd

**© 2016 UNIPOWER LLC  
All Rights Reserved**

Copyright © 1999-2016 UNIPOWER LLC

All Rights Reserved

**Restricted Rights Legend:**

Use, duplication, or disclosure by the Government is subject to restrictions as set forth in subparagraph © (1)(ii) of the Rights in Technical Data and Computer Software clause at DFARS 252.227-7013 or subparagraphs © (1) and (2) of Commercial Computer Software - Restricted Rights at 48 CFR 52.227-19, as applicable.

For Contact Information, please go to <http://www.unipowerco.com/contact/>

Refer to the UNIPOWER License Agreement in this package before installing or using this product.

Unless specifically noted, all addresses, data characters and persons referenced herein, and all examples involving names of companies and products, are fictitious examples and are designed solely to illustrate the use of UNIPOWER products.

Product names, logos, brands, and other trademarks featured or referred to within this product manual are the property of their respective trademark holders. These trademark holders are not affiliated with UNIPOWER LLC or our products. They do not sponsor or endorse our products.

## **LIMITATIONS AND AUTHORIZATIONS FOR USE AND PERMITTED APPLICATIONS**

UNIPOWER's products are not designed, intended for use in, or authorized for use as critical components in, human life support systems/equipment, equipment used in hazardous environments, or equipment used in nuclear control equipment or systems. Any such use requires the prior express written consent of an authorized executive officer of UNIPOWER LLC, which consent may be withheld by UNIPOWER LLC in its sole discretion. Users assume all risk and liability for, and agree to indemnify and defend UNIPOWER from and against any claims for personal injury (including death) or property damage resulting from any such use or application which is made in the absence of such prior express written consent.

If you find errors or problems with this documentation, please notify UNIPOWER. UNIPOWER does not guarantee that this document is error-free. The information in this document is subject to change without notice.

September 2015

## Contents

<b>Chapter 1 About This Manual .....</b>	<b>6</b>
1.1 Objectives .....	6
1.2 Audience .....	6
1.3 Document Key .....	6
1.4 Feedback & Support .....	7
 <b>Chapter 2 Aspiro System Description .....</b>	 <b>8</b>
2.1 Overview .....	8
2.2 System Configurations .....	8
2.3 System Parameters .....	9
2.4 System Components.....	12
2.4.1 System Controller .....	12
2.4.2 DC Distribution.....	12
2.4.4 Rectifier Module .....	12
2.5 Operation.....	14
 <b>Chapter 3 System Safety.....</b>	 <b>15</b>
3.1 Safety Warnings and Guidelines .....	15
3.1.1 System Markings .....	15
3.1.2 Safety Recommendations.....	15
3.1.3 Installation Warning.....	16
3.1.4 Restricted Access Area Warnings.....	16
3.1.5 Electrical and Fire Enclosure .....	16
3.1.6 System Enclosure.....	16
3.1.7 Operating Temperature Warnings .....	16
3.1.8 Electrical Safety Warnings.....	16
3.1.9 Grounding .....	17
3.1.10 Batteries .....	18
3.1.10.1 Lead Acid Batteries.....	18
3.1.11 In Case of an Accident .....	18
3.2 Caution.....	19
3.2.1 Storage and Transportation .....	19
3.2.2 Disposal.....	19
3.2.3 Handling Electrostatic Sensitive Devices .....	19
3.2.4 Traceability .....	19
3.2.5 Breakers .....	19
3.2.6 Hot Surfaces.....	19

<b>Chapter 4 Installation Guide .....</b>	<b>20</b>
4.1 Introduction.....	20
4.2 Unpacking.....	20
4.3 Tools .....	20
4.4 Rack Mounting.....	20
4.5 Rear Connections .....	22
4.5.1 DC Earth Connection.....	22
4.5.2 Mains Connection .....	23
4.5.3 Alarm and Signal Connections.....	24
4.5.3.1 Cable Relief Kit .....	25
4.5.4 DC Load Connections.....	26
4.5.4.1 Circuit Breaker Limitations .....	26
4.5.5 Battery Connections .....	27
4.5.6 Symmetry Connection .....	28
4.5.7 Temperature Sensor Connection .....	29
<b>Chapter 5 Commissioning.....</b>	<b>30</b>
5.1 Commissioning Overview .....	30
5.2 Tools and Test Equipment.....	30
5.2.1 Tools List.....	30
5.2.2 Test Equipment .....	30
5.3 Preparation .....	30
5.4 Commissioning procedure .....	31
5.5 Test of output voltage.....	32
5.5.1 Float charge (U1) .....	32
5.5.2 Adjustment of Float Charge, U1 .....	32
5.5.3 Boost charging (U2) (if applicable) .....	32
5.6 Battery supervision .....	33
5.7 Battery test .....	33
5.8 Commissioning record .....	34
<b>Chapter 6 Maintenance &amp; Troubleshooting .....</b>	<b>35</b>
6.1 Maintenance.....	35
6.2 Troubleshooting .....	35
<b>Chapter 7 Replacing Modules.....</b>	<b>39</b>
7.1 Controller Replacement .....	39
7.2 Rectifier Replacement.....	40
7.2.1 XR04.48 / XR08.48 Replacement .....	40
7.2.2 XPG12.48 Replacement.....	40
7.3 Breaker Replacement .....	41
<b>Appendix A - Block Diagram .....</b>	<b>42</b>

## FIGURES

Figure 2-1	Power System Overview.....	8
Figure 2-2	Distribution Breaker Options.....	12
Figure 2-2	XPGe12.48 and XR04.48/XR08.48.....	13
Figure 4-1	Dimensional Drawing (Front and Top View).....	21
Figure 4-2	System Mounting (19" mount) .....	21
Figure 4-3	Rear Connections .....	22
Figure 4-4	DC Earth Connections .....	22
Figure 4-5	Mains Connection (viewed from rear).....	23
Figure 4-6	Mains Connection Detail .....	24
Figure 4-7	Signal Connection Detail .....	24
Figure 4-8	Signal Pin Designations .....	25
Figure 4-9	Cable Relief Kit .....	25
Figure 4-9	Load Connections (Rear View).....	26
Figure 4-10	2-block Symmetry Measurement (for illustration only) .....	28
Figure 4-11	4-Block Symmetry Measurement (for illustration only) .....	28
Figure 4-12	Temperature Sensor Connection .....	29
Figure 7-1	Unlocking and removing the Controller .....	39
Figure 7-2	Replacing an XPGe12.48 Rectifier.....	40
Figure 7-5	Breaker Replacement .....	41

## TABLES

Table 4-1	Recommended Mains Circuit Protection.....	23
Table 4-2	Cable Sizes.....	26
Table 5-1	Float/Boost Charge Voltages.....	32
Table 5-2	Commissioning Record.....	34

## 1. About This Manual

This chapter contains an overview of the information that is presented in this Power System Manual. This includes information on objectives, the intended audience, and the organization of this manual. In addition, this chapter also defines the conventions used to indicate warnings, cautions and noteworthy information.

### 1.1 Objectives

This manual describes the Power System, explains how to unpack and install the system, how to perform the initial power-up and operational system check.

The information presented in this document is current as of the publication date.

### 1.2 Audience

This manual is to be used by installers and technicians who are preparing the site for a new installation and installing the power system. This manual assumes that the technician has an understanding of power systems in general and understands safety procedures for working around AC and DC voltage.

The user of this document should be familiar with electronic circuitry and wiring practices and have some expertise as an electronic, power, or electromechanical technician.

### 1.3 Document Key

This manual uses the following conventions:



**WARNING** This symbol indicates a situation that could cause bodily injury. Always be aware of hazardous conditions when working in or around the power system.



**CAUTION** This symbol indicates a situation that might result in equipment damage. The reader should be aware that their actions could result in equipment or data loss.



**NEED MORE INFORMATION?** This symbol is used to reference information either in this manual or in another document.



**NOTE** This symbol means the reader should take note. Notes are helpful suggestions or reminders.

Table 1-1 Abbreviations

Abbreviation	Description
PPS	P1 Power Supply System
PMP	P1 Modular Power
CMP	Convection-cooled Modular Power
FMP	Fan-cooled Modular Power
PCS	P1 Control and Supervision
PCU	P1 Control Unit
GMC	Galero Modular Controller
PPR	P1 Power Rack
PBDU	P1 Battery Distribution Unit
PBC	P1 Battery Cabinet
PDU	P1 Distribution Unit
PPRD	P1 Power Rack with DC Distribution
PPC	P1 Power Supply Cabinet
PBF	P1 Battery Fuse Unit
PCB	Printed Circuit Board
LVD	Low voltage disconnection
PLD	Partial load disconnection
MCB	Miniature circuit breaker
MCCB	Moulded case circuit breaker

## 1.4 Feedback & Support

For technical support or feedback, please visit <http://www.unipowerco.com/contact/> and select Customer “Support/Repairs” and then “Customer Service”.

Alternatively, email: [sales@unipowerco.com](mailto:sales@unipowerco.com)

## 1.5 Disclaimer

UNIPOWER is not responsible for system problems that are the result of installation or modification of the instructions provided in this manual.

### 2.1 Overview

Aspiro DC power systems offer a range of solutions for diverse applications such as broadband access, cable head ends, micro/pico BTS Cells, Enterprise, E911, and GSM-R.

The Aspiro shelf system utilizes efficient, dense, and reliable plug-in rectifier modules XR04.48, XR08.48 or XPGe12.48, with output power available at either 400W, 800W or 1200W per rectifier, based upon a soft-switching approach. Features include wide input operating range, wide operating temperature, full self-protection and three LEDs for immediate rectifier status indication.

The power system can be managed locally through messages and alarm displayed on the LCD screen of the system controller or remotely, using the PC-based PowCom™ software, or through a web browser with Ethernet connection.

### 2.2 System Configurations

Aspiro 1U system consists of:

1. System Controller ACC Extended or PCC
2. 4 x Load and 1 x Battery breakers including LVD
3. XR04.48 / XR08.48 / XPGe12.48 Rectifiers (Maximum 2)
4. Rear Connections

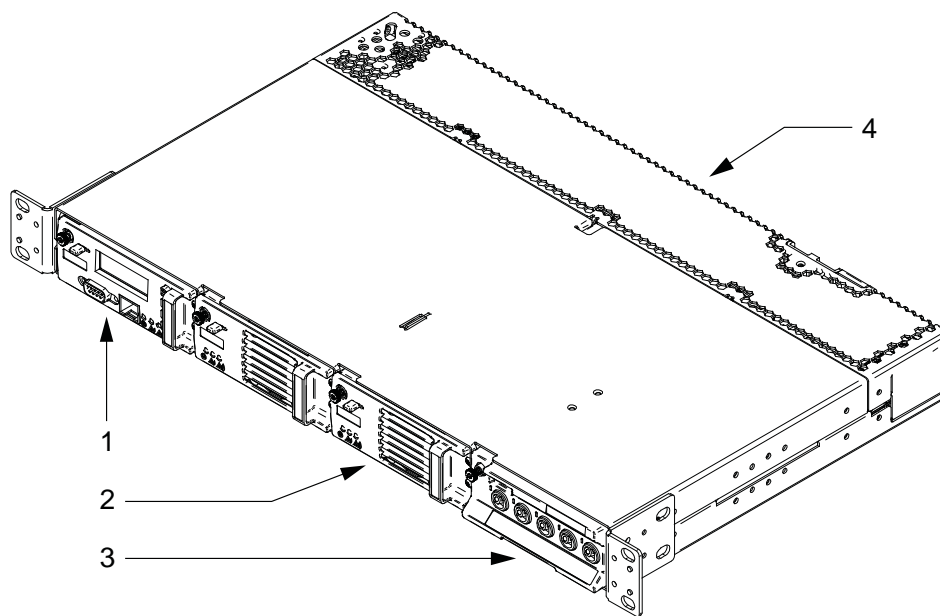

*Figure 2-1 Power System Overview*



## 2.3 System Parameters

### OUTPUT

---

Power (max)	2400W @ >180VAC, 800W @ <180VAC
Output Current (max)	24A (XPG <sub>e</sub> 12.48), 18.6A (XR08.48), 11A (XR04.48)
Float Voltage	53.5VDC
Voltage Range	46-57VDC

### INPUT

---

Voltage	85-300VAC (Single-phase, 2 x Single-phase)
Frequency	50-60Hz
Input Current	16A (Single-phase), 8A (2 x Single-phase)
Power factor	>0.98

### DC DISTRIBUTION

---

Battery Breakers	1 (with appropriate option selected)
Load Breakers	4 or 5 (depending on option selected)
Ratings	4A, 5A, 7½A, 10A or 15A

### MONITORING AND CONTROL

---

Controller	PCC or ACC Extended
Local Interface	4 x 20" LCD, 4-key menu, USB (ACC only) and RS232
Remote Interface	Ethernet / Modem using PowCom™ software
Visual Indication	Green LED - System On Yellow LED - Message(s) Red LED - Alarm(s)
Analog Inputs	12 x voltage inputs (range 0-100VDC) - used for symmetry inputs
Analog Outputs	4 x potential free relays (C, NC, NO)
Digital Inputs	2 x, Logic 0: U<10VDC, Logic 1: U>12VDC
Digital Outputs	2 x, open collector type
Temperature measurement	2 x Temperature probe (Battery, Ambient)

### CONNECTIONS

---

Battery connections	Stripped cable, max. 16mm <sup>2</sup> , spring type connector
AC connections	Stripped cable with ferule, max. 2.5mm <sup>2</sup> , screw type connector
Load breaker connections	Stripped cable with ferule, max. 4mm <sup>2</sup> , screw type connector
Alarm connections	Stripped cable with ferule, max. 1.5mm <sup>2</sup> , screw type connector

---

**MECHANICAL**

---

Dimensions (WxHxD)	482.6mm x 44.45mm x 280mm
Weight of the system (fully equipped)	6.5 kg
Mounting Options	19"/ ETSI / Mid-mount
Cable Entry	Rear Access
Enclosure	IP20

---

**STANDARD COMPLIANCE / ENVIRONMENTAL**

---

***Emissions***

Conducted	CISPR 22/EN 55022/EN 61204, GR1089, R-3-6 Class B
Radiated	CISPR 22/EN 55022/EN 61204 Class B
Harmonics	IEC/EN 61000-3-2
Voltage fluctuation and flicker	IEC/EN 61000-3-3
Voltage Sag	SEMI F47-0200 (230VAC)

***Immunity***

ESD	IEC/EN 61000-4-2, level 4 (contact/air) 8/15kV - Performance criterion B
Electromagnetic Field	IEC/EN 61000-4-3, level 3 10V/m - Performance criterion A
Fast Transients	IEC/EN 61000-4-4, level 3 (in/out) 2/1kV - Performance criterion B
Surges	Surges - IEC/EN 61000-4-5, level 3 (L/L, L/E) 2/4kV - Performance criterion B Telecordia GR-1089-cove, level 2 (L/L, L/E) 6/6kV - Performance criterion D
Voltage dips and interruptions	IEC/EN 61000-4-11 Dip 30%, 100ms - Performance criterion A Dip 30%, 200ms - Performance criterion B Dip 60%, 20ms - Performance criterion A Dip 60%, 100ms - Performance criterion B Dip >95%, 20ms - Performance criterion A Dip >95%, 100ms - Performance criterion B
Conducted RF	IEC/EN 61000-4-6 10VAC, AM 80%, 1kHz - Performance criterion A
Safety	EN 60950-1
Environment	Storage - ETS 300 019-2-1 Transport - ETS 300 019-2-2 Operation - ETS 300 019-2-3
Operating Temperature	-40°C to +75°C
Storage Temperature	-40°C to +85°C

RECTIFIER MODEL	XPGe12.48	XR08.48	XR04.48
Efficiency	95% typical @ I <sub>out</sub> nom	90% typical @ I <sub>out</sub> nom	88% typical @ I <sub>out</sub> nom
Input Current (max)	<7.3A	<10.5A	<5.3A
Output Current (max)	22.4A	15.0A	7.5A
53.5V float			
Output Power	1200W @ >180VAC 750W @ 90-180VAC	800W	400W
Operating Temperature (without derating)	55°C	65°C	65°C
Input Voltage (Nominal 100-240VAC)	90-300VAC	85-300VAC	
Output Voltage	46-57VDC		
Load sharing	< 5% of nominal current		
Dimensions (WxHxD)	40.6 (1.6") x 101.62(4") x 228.5(9") mm		
Weight	1.1 kg		
Cooling	Fan-cooled, speed and alarm controlled, air flow direction rear to front		
Protection	Short circuit proof, automatic current limiting, selective shutdown of modules at excessive output voltage.		
Alarms	High output voltage/ shutdown, Low voltage/ module failure		
LED Indication	<b>Green:</b>	Power ON	
	<b>Yellow:</b>	Current limit/ thermal protection	
		Fan failure / Over temperature	
		Pre-warning / thermal protection	
		Communication Failure (flashing)	
	<b>Red:</b>	Module failure / high output voltage shutdown	
Audible noise	<55dBA according to ISO7779		

## 2.4 System Components

The Aspiro system is delivered with all components mounted according to the ordered configuration. The main components are described below and in later chapters of the manual.

### 2.4.1 System Controller

The Aspiro 1U power system can be controlled by the ACC Extended or PCC controller. The description and operation of these controllers is covered in separate manuals which are available at:

ACC Extended: <http://www.unipowerco.com/pdf/acc-man.pdf>

PCC: <http://www.unipowerco.com/pdf/pcc-man.pdf>

### 2.4.2 DC Distribution

The Aspiro 1U system is available with two distribution options as below:

- 5 x Load Breaker B-Frame type drawer
- 4 x Load and 1 x Battery breaker drawer, includes LVD

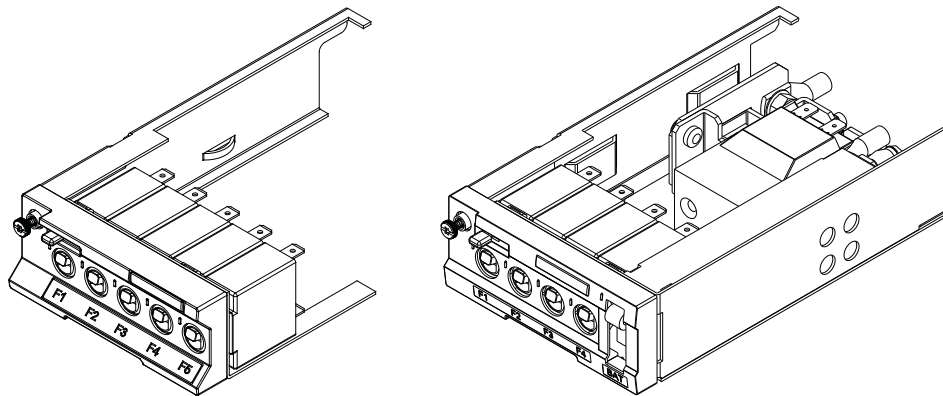

*Figure 2-2 Distribution Breaker Options*

### 2.4.4 Rectifier Module

The Fan-Cooled XPG<sub>e</sub>12.48 (1200W), XR08.48 (800W) and XR04.48 (400W) rectifiers are modular power supplies designed for parallel operation and hot-plug installation in the Aspiro Power Systems.

Each rectifier provides extremely reliable DC power in a very high density. The module incorporates power monitoring through an internal microprocessor, giving up to the second updates to the system controller and companion rectifiers. This guarantees

tightly controlled load sharing among rectifiers, and provides status and identification information to the controller.

The rectifiers operate in parallel using active load sharing. They incorporate soft-start at both the input and the output, which protects against high incoming and outgoing currents. The output voltage of the rectifier is automatically adjusted to the required voltage by the controller.

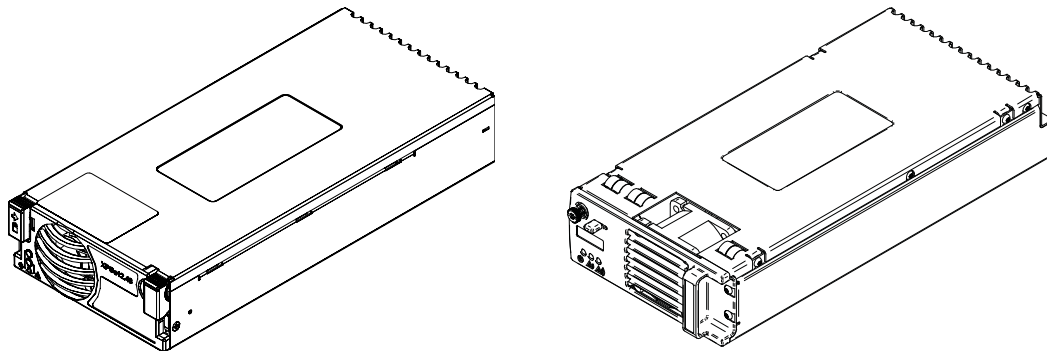

*Figure 2-2 XPG12.48 and XR04.48/XR08.48*

XPG12.48 rectifiers cannot be used in the same rack as XR04.48 / XR08.48 rectifiers.



---

**CAUTION** XPG12.48 rectifiers cannot be used in the same system as XR04.48/XR08.48 rectifiers.

---

## 2.5 Operation

The Aspiro system is capable of delivering up to 2400W/48V steady state power. The system is based on hot swappable rectifier modules which work in parallel with automatic load sharing.

The power shelf is normally configured with N+1 redundancy (1200W max.), with N as the number of rectifier modules necessary for feeding the load and charging the battery and 1 as the redundant rectifier module. In normal operation the rectifier modules are feeding the load.

The system performance is supervised and controlled from the system controller. From this unit, system settings such as output DC voltage and alarm thresholds are set. Any system malfunction will be indicated by front panel LED indicators, text in the LCD and operation of dry contacts. However, the controller is not a single point of failure. In the event of malfunction in the controller, basic tasks like feeding the load will be maintained by the rectifier modules directly at preset default values.

The alarm and threshold setting of the Aspiro system can be set locally by use of the controller push buttons and menu guided operation, or remotely using either the PowCom™ program or the Web Interface.

### 3.1 Safety Warnings and Guidelines

The following warnings and guidelines should be followed by properly trained and authorized personnel when installing, operating, commissioning or maintaining this equipment. Neglecting the instructions may be dangerous to personnel and equipment.

#### 3.1.1 System Markings

The following markings are found on the Power System:

##### Ground Symbol



##### DC Ground Symbol



**Product Label** - The product label contains the system part number, model number, system ratings and safety approvals. The label is located on the left side of top cover.

#### 3.1.2 Safety Recommendations

Any device that uses electricity requires proper guidelines to ensure safety.

- The Power System should only be installed or serviced by a qualified personnel.
- Always keep tools away from walkways and aisles. Tools present a tripping hazard in confined areas.
- Keep the system area clear and dust-free during and after the installation.
- Always know the location of emergency shut-off switches in case of an accident.
- Always wear appropriate eye protection and use appropriate tools for working with high voltage equipment.
- Do not perform any action that creates a potential hazard to other people in the system area.
- Never work alone in potentially hazardous conditions.
- Always check for possible hazards before beginning work.
- Remove watches, rings and jewelry that may present a hazard while working on the power system.

### 3.1.3 Installation Warning

The following safety guidelines should be observed when transporting or moving the system:

- Before moving the Power System, read the system specifications sheet to determine whether the install site meets all the size, environmental, and power requirements.
- The system and the equipment included, should only be moved and installed by qualified personnel to prevent bodily injury or any other hazardous conditions.

### 3.1.4 Restricted Access Area Warnings

The Power System is designed for installation in locations with restricted access often secured by a locking mechanism. It can therefore be accessed only by a trained service person, who is fully aware of the restrictions applied to the location, or by an authority responsible for the location.

### 3.1.5 Electrical and Fire Enclosure

The unit is for building-in. A suitable Electrical and Fire enclosure shall be provided.

### 3.1.6 System Enclosure

Appropriate measures need to be taken to avoid intrusion of any unwanted objects or insects into conductive areas of the power system as there is a potential risk of system damage.

**Disclaimer:** UNIPOWER LLC assumes no liability or responsibility for system failures resulting from inappropriate enclosure around the system.

### 3.1.7 Operating Temperature Warnings

To prevent the Power System from overheating, an automatic shutdown mechanism has been installed. It is not recommended to continually operate the Power System in an area that exceeds the maximum recommended operating temperature.

### 3.1.8 Electrical Safety Warnings

The following are electrical safety recommendations for working near the Power System:



---

**WARNING** Observe low voltage safety precautions before attempting to work on the system when power is connected. Potentially lethal voltages are present within the system.

---





---

**WARNING** Caution must be exercised when handling system power cables. Damage to the insulation or contact points of cables can cause contact with lethal voltages. For safety reasons, cables should be connected to the power system before power is applied.

---

- Remove all metallic jewelry like watches or rings that may present a hazard while working on the power system.
- Before connecting the AC input source to the power system, always verify voltage.
- Verify the AC source capacity. See system specifications for AC information.
- All AC connections must conform to local codes and regulations, e.g. ANSI, CEC, NEC, etc.
- When making AC connections, all AC power and DC load distribution breakers should be in the OFF position.
- All circuit breakers should meet the original design specifications of the system. In addition, equipment connected to the system should not overload the circuit breakers as this may have a negative effect on overcurrent protection and supply wiring, causing system or user harm.
- Verify the DC capacity before making connections. See system specifications for DC information.
- Potentially lethal voltages are present within the system. Ensure that all power supplies are completely isolated by turning all power switches OFF, disconnecting all relevant connectors and removing all relevant breakers before attempting any maintenance work. Do not rely on switches alone to isolate the power supply. Batteries should also be disconnected.
- Potentially lethal voltages are present within this system. Ensure that low voltage safety requirements are implemented before attempting to work on the system with power connected.
- Potentially lethal voltages can be induced if the equipment is not grounded (earthed) correctly. Ensure that all ground connections are secure.

### 3.1.9 Grounding



---

**WARNING** Grounding connection must be performed before operating the system. Refer to local codes, e.g. ANSI, CEC, NEC, T1-333, ETSI 300-386-TC specifying the connection of power system to building ground. In case of any doubt regarding the grounding connection, please contact a person responsible for the system.

---



---

**WARNING** The system should be hard-wired to the incoming earth ground. A solid high current ground connection capable of sinking the maximum system current is required.

---

### 3.1.10 Batteries



---

**WARNING** When installing or replacing batteries, there is risk of explosion if an incorrect battery type is used.

---

#### 3.1.10.1 Lead Acid Batteries



---

**WARNING** This equipment may use Lead Acid Batteries. When handling batteries, follow the instructions included with the battery set, as the fluids contained within these batteries are known to be a health hazard. The disposal of lead acid batteries is subject to legal requirements for hazardous waste disposal. Local guidelines should be followed for disposal.

---

Ensure the following guidelines are observed when dealing with equipment that may contain lead acid batteries:

- Any attempt to burn these batteries may result in an explosion and the generation of toxic fumes.
- Should a lead acid battery suffer damage, it must be moved into a well-ventilated area. Contact with the corrosive fluid must be avoided.
- Neutralize any acid corrosion with copious amounts of a solution of baking soda and water, and then wipe off all traces of soda.
- If the lead acid battery is removed from the equipment, any exposed contact must be insulated prior to disposal.
- Ensure that protective full-face shields, rubber gloves and aprons are worn and insulated tools are used when working with the batteries. It is advised also to have water available in case acid gets in contact with the eyes.

#### 3.1.11 In Case of an Accident

In the event of an accident resulting in injury:

1. Use caution and check for hazards in the area.
2. Disconnect power to the system.
3. If possible, send someone to get medical aid. If not, check the condition of the victim and call for help.

## 3.2 Caution

### 3.2.1 Storage and Transportation



**CAUTION** During storage and transportation, the units must remain in their original packages in order to avoid mechanical damage, maintain tracability, and protect the units against electrostatic discharge.

### 3.2.2 Disposal



**CAUTION** The product should not be disposed with other wastes at the end of its working life so as to prevent possible harm to the environment or human health from uncontrolled waste disposal.

### 3.2.3 Handling Electrostatic Sensitive Devices



**CAUTION** An electrostatic sensitive device is an electronic component that may be permanently damaged by the discharge of electrostatic charges encountered in routine handling, testing and transportation.

### 3.2.4 Traceability



**CAUTION** Units are labeled with permanently attached product identification labels. The labels are designed to be indelible throughout the life span of the equipment, unless mistreated. Make sure that the product identification labels are present on the equipment and are not subjected to unusual wear or mistreatment.

### 3.2.5 Breakers



**CAUTION** Breakers should always be replaced with the same type and rating in order to avoid damage to system components.

### 3.2.6 Hot Surfaces



**CAUTION** Areas of the Power System may become hot. Take precautions and handle with care to avoid harm.



---

**WARNING** There are potential hazards related to installing this power system. It is important to carefully read and understand the contents of Chapter 3 System Safety before performing system installation.

---



---

**CAUTION** Make sure sufficient room is left around the system, enabling optimal air circulation and thus preventing the system from overheating. Keep vent openings from blocking.

---

### 4.1 Introduction

This chapter provides detailed instructions for installing the Aspiro 1U Power System.

### 4.2 Unpacking

Check that the received equipment is in accordance with the packing list. Ensure that the cabinet and the equipment have not been damaged during transportation.

Report any parts that are damaged, missing or incorrect. If possible, correct the problem before continuing.

### 4.3 Tools

The following tools are required for a safe installation of the system:



---

**WARNING** Use only single-ended, fully insulated tools. Shafts of for example screwdrivers should be insulated.

---

- Anti-static hand strap.
- Insulated socket wrench .
- Insulated screwdriver set, flat.
- Insulated Screwdriver set, torx.
- Insulated screwdrivers, pozidrive (cross-slot), sizes 1, 2, and 3.
- Insulated torque spanner (for battery connection).

### 4.4 Rack Mounting

The power system is designed for rack mounting, and the default bracket is for 19 inch rack width. This bracket can be easily adjusted to 23” or ETSI mounting. See Figure 4-1.

The brackets are front mounted but can be moved by the user for center mount rack setup.

There needs to be sufficient clearance at the front for rectifier installation, and at the rear for connections. When using side mains and DC connectors, sufficient space should be allowed for access in this case.

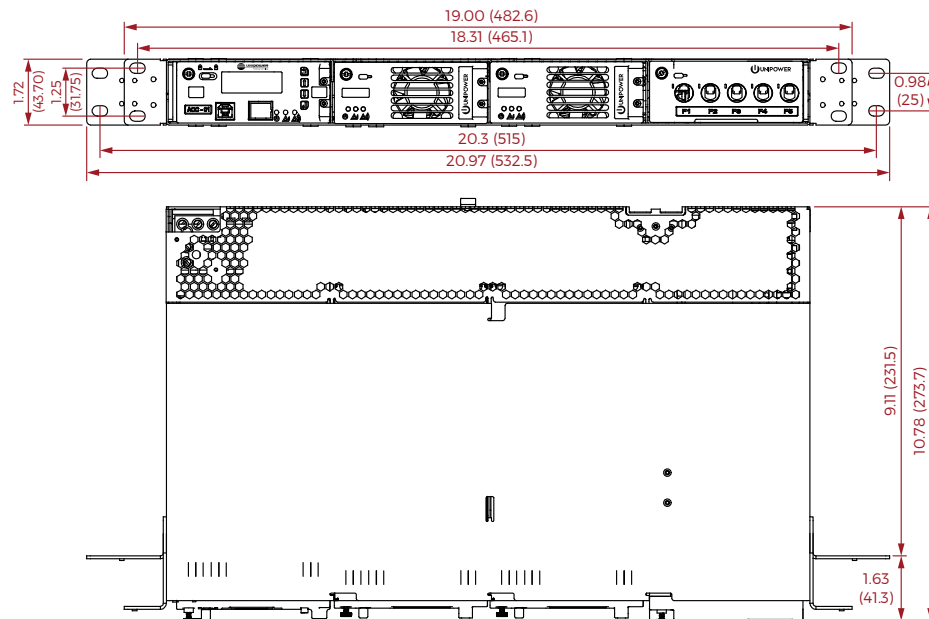
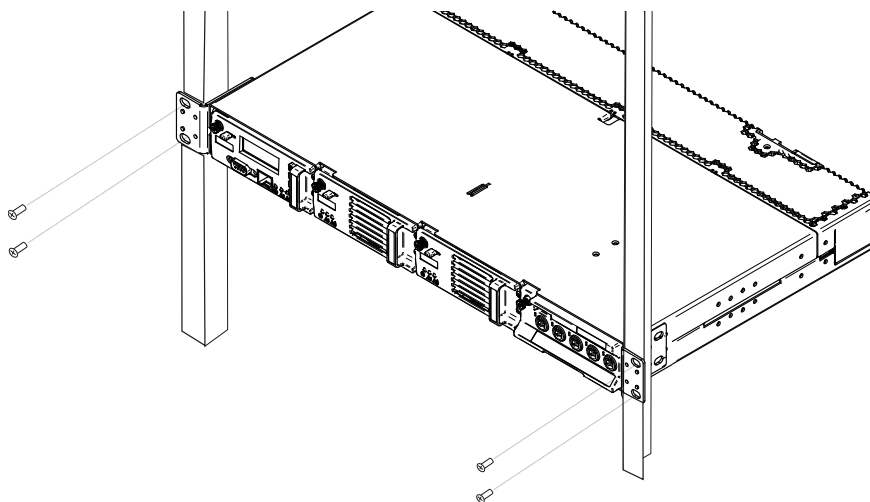

**Figure 4-1 Dimensional Drawing (Front and Top View)**

The Aspiro system can be easily mounted to a rack using the supplied taptite screws to fasten the mounting brackets to the rack as shown in Figure 4-2.



**NOTE** It is recommended to remove the rectifiers before installing the shelf to the cabinet or rack.



**Figure 4-2 System Mounting (19" mount)**

## 4.5 Rear Connections

All cable connections for the Aspiro systems are available at the rear of the system. Load and battery connections are performed at the rear of the breaker drawer, see Figure 4-3.



**CAUTION** Recommended wire sizes for mm<sup>2</sup> and AWG in the following are not given as exact conversions, but as recommended sizes in standard values for each system. Wires should be rated for 90°C and minimum 300V rating.



**WARNING** Before inserting the cable into the connector, remove as little insulation on the cable as possible, to prevent the stranded conductor to come loose and touch any other conductive parts.

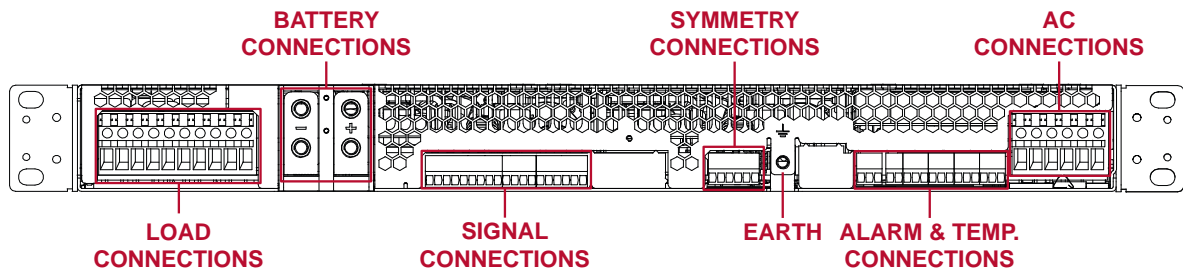

*Figure 4-3 Rear Connections*

### 4.5.1 DC Earth Connection



**WARNING** The power system needs to be properly grounded to the rack or cabinet frame to ensure its safe and efficient operation.

Earth Connection of the rack can be made by using the M5 screw located on the rear as shown in Figure 4-4. Earth connection is essential before connecting the mains to the power system. Use a suitable cable lug for connection (M5) and a UL listed cable.

To connect:

1. Loosen the screw (M5).
2. Attach suitably sized cable lug.
3. Tighten the screw with torque 3.5Nm.  
Recommended cable size is 6mm<sup>2</sup> / 10AWG.

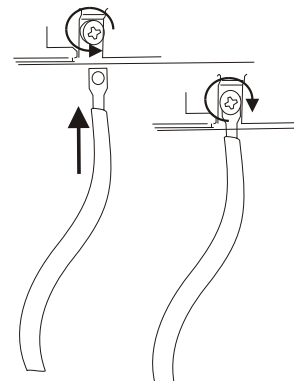

*Figure 4-4 DC Earth Connections*

## 4.5.2 Mains Connection



**WARNING** Ensure that mains input is turned off before connecting. The grounding must be connected to PE terminal as first.



**CAUTION** Depending on deployment region with regards to lightning strikes and heavy inductive energy, it is highly recommended to install AC Surge Protection Class C.

The Aspiro system family is available with two options for mains connection:

- Single-phase / Phase to Phase (USA) connection
- 2 x Single-phase / Phase to Phase (USA) connection

First, check which mains solution is delivered and then follow the appropriate installation instructions below.

Connectors are situated on the right rear side of the system (Figure 4-3), labeled and configured as seen in Figure 4-5.

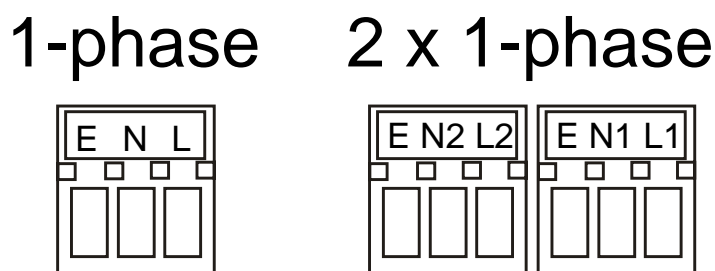

*Figure 4-5 Mains Connection (viewed from rear)*

Shelf Type (See product label)	Number of Rectifiers	I <sub>max</sub> at 100 VAC	Recommended Mains CB
Single-phase AC Input	2	18.6 A at 100VAC	D63A
2 x Single-phase AC Input	2	9.3 A at 100VAC	2 x D63A

*Table 4-1 Recommended Mains Circuit Protection*

To connect:

1. Remove sufficient insulation from the cables and insert stripped cables into the appropriate terminal.
2. Tighten the corresponding terminal screw with a flat screwdriver, see Figure 4-6.

Maximum cable size is 4mm<sup>2</sup> / 12AWG.  
Maximum torque required for tightening the screw is 0.5Nm.

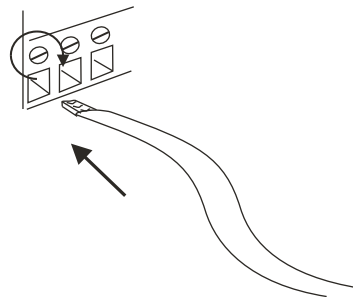

*Figure 4-6 Mains Connection Detail*

### 4.5.3 Alarm and Signal Connections

Configuration-specific Alarm Outputs, Symmetry Measurement Inputs and optional signals are found on the right side and center as seen from the rear, see figure 4-8 for details. The Symmetry inputs can also be reconfigured as external inputs. The configuration of alarms and symmetry connections may vary depending on controller configuration.



**NOTE** Each alarm contact represents a different alarm condition or conditions. These are defined in the controller's alarm matrix setup.

To connect:

1. Release a connector from the terminal using a screwdriver and pull it out.
2. Remove sufficient insulation from the cables and insert stripped cables into the appropriate connector. Then tighten the corresponding terminal screw using a flat screwdriver Figure 4-8.
3. After fastening all the cables, insert the connector back into the terminal block.

Maximum cable size is 1.5mm<sup>2</sup> 16AWG.  
Maximum torque required for tightening the screw is 0.25Nm.

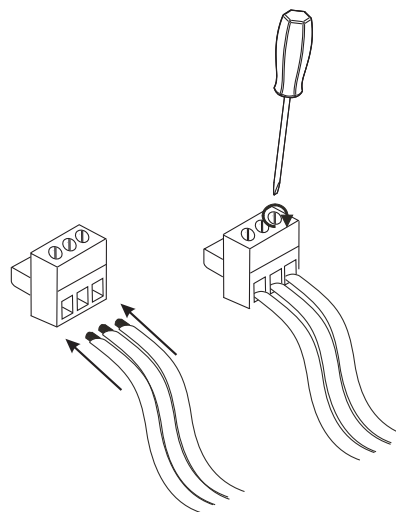

*Figure 4-7 Signal Connection Detail*



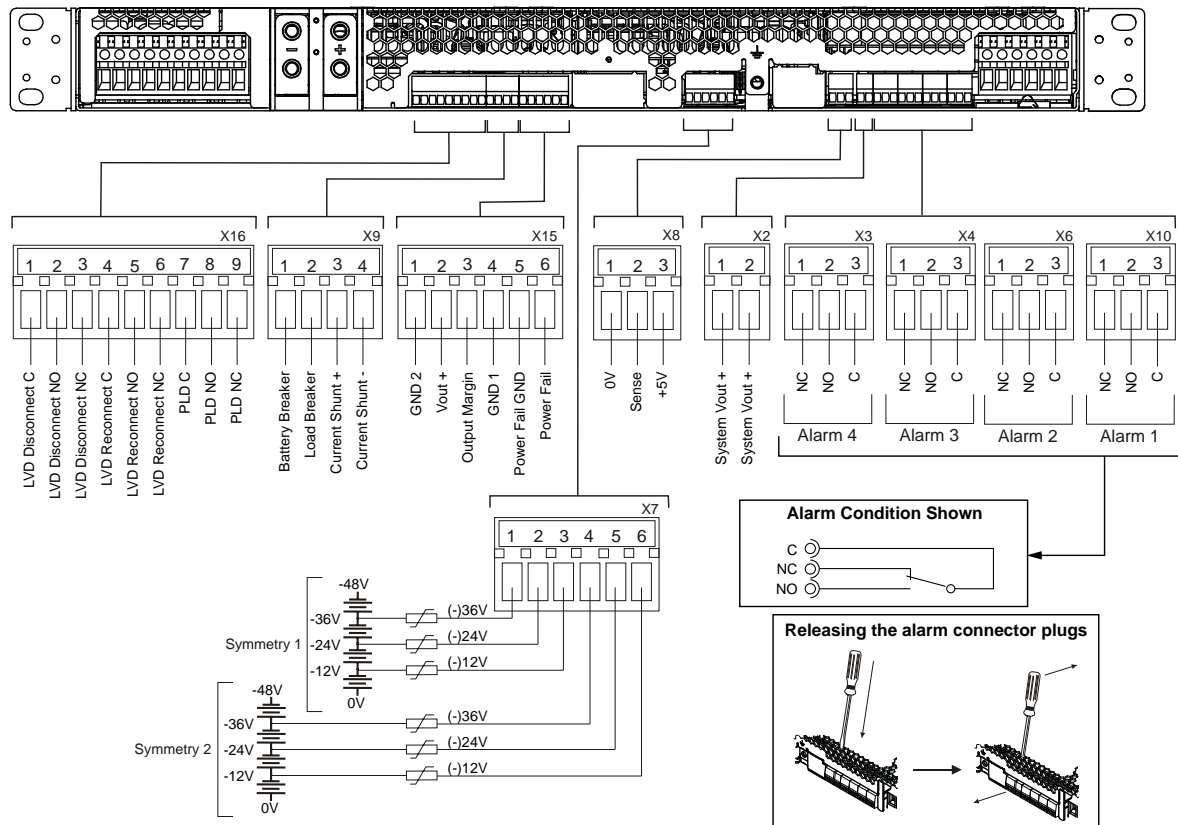

**Figure 4-8 Signal Pin Designations**



**NOTE** With XR04.48 rectifiers mounted, it is recommended to pull the mains cable through the supplied ferrite to guarantee EN55022 Class B EMC standard compliance.

#### 4.5.3.1 Cable Relief Kit

The Aspiro power system is delivered with a kit for mounting a mains cable relief near the mains connector. The kit may be mounted according to customer needs as shown in Figure 4-9.

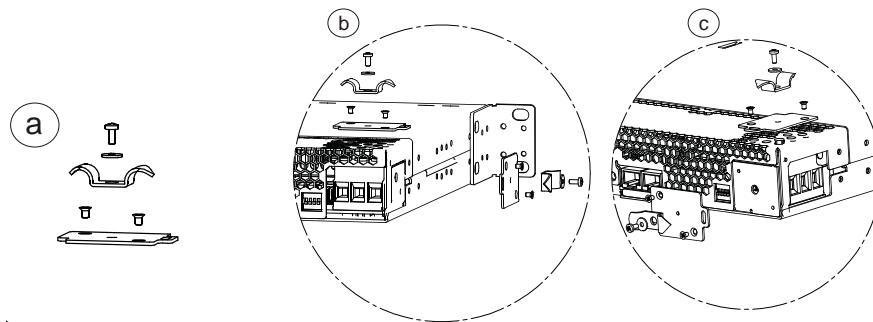

**Figure 4-9 Cable Relief Kit**

#### 4.5.4 DC Load Connections

Load Connections are available at the rear, with connections labeled corresponding to each load breaker, Figure 4-9.

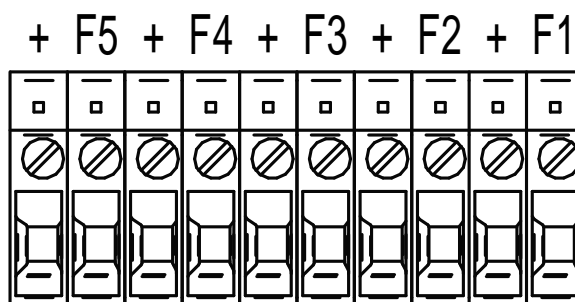

*Figure 4-9 Load Connections (Rear View)*

For DC load connections use the instructions given in Figure 4-6.

Maximum cable size is 4.0mm<sup>2</sup> / 12AWG. Maximum torque required for tightening the screw is 0.6Nm.



**CAUTION** For correct electrical polarity of DC loads see connector labels.

Load Breaker Size [A]	4A	5A	7.5A	10A	15A
Wire Size [mm <sup>2</sup> /AWG]	1/18	1/18	1/18	1/18	2.5/14

*Table 4-2 Cable Sizes*

##### 4.5.4.1 Circuit Breaker Limitations

The following breaker limitations apply. Ambient temperature below means the temperature of the inflow air to the system.

- 50°C Ambient - 40A max. total, 25A max. each breaker
- 65°C Ambient - 25A max. total, 12A max. each breaker

At 50°C ambient temperature all circuit breakers should be loaded to a maximum of 80% rating. In addition, the following limitations apply:

- 15A breakers require one free space between breakers.
- Maximum battery charging is 50A.

At 65°C ambient temperature all circuit breakers should be loaded to a maximum of 70% rating. In addition, the following limitations apply:

- When using circuit breakers rated 15A the maximum load per circuit breaker is 60% of the rating. When using circuit breakers rated 15A one free space is required between circuit breakers. Maximum combined input current is 28A.
- Maximum battery charging 50A.

At 75°C ambient temperature all circuit breakers should be loaded to a maximum of 50% rating. In addition, the following limitations apply:

- When using circuit breakers rated 4A to 10A maximum load per circuit breaker is 50% of the rating. When using circuit breakers rated 15A, the maximum load per circuit breaker is 40% of the rating. When using circuit breakers rated 15A, one free space is required between circuit breakers. Maximum combined input current is 18A.

#### 4.5.5 Battery Connections



---

**WARNING** Improper handling with batteries can be dangerous. Please read and understand the information in the Safety chapter before connecting batteries.

---



---

**CAUTION** Follow closely the battery manufacturer's specifications regarding the maximum battery charge current value.

---



---

**WARNING** The battery cables should be connected to the shelf first, then to the batteries. If the battery cables are already connected to the batteries disconnect the -48 V cable from the battery at least.

---

Battery connections are available at the rear of the system adjacent to the load connections, see Figure 4-3, and are marker - and +. It is recommended to use 45 degree angled cable lugs. The fixing screws are size M6, and the cable lug can be maximum 15mm wide. Recommended torque is 8Nm.

### 4.5.6 Symmetry Connection

1. Attach the interblock connection plates between the batteries.
2. Insert a suitably sized cable lug into one pole of the interblock connection plate. Fasten the lugs and plates to individual battery poles.
3. For 2-block battery symmetry measurement fix one wire of the symmetry cable to the cable lug in the mid-point of the battery string, see Figure 4-10.
4. For 4-block measurement fix the 3 wires (red, green and blue) of the symmetry cable to individual cable lugs. Colour coding of the cables must be respected for proper symmetry measurement see Figure 4-11.

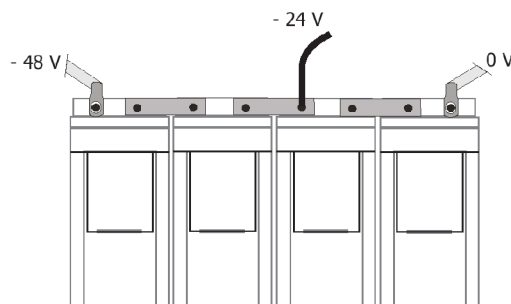

*Figure 4-10 2-block Symmetry Measurement (for illustration only)*

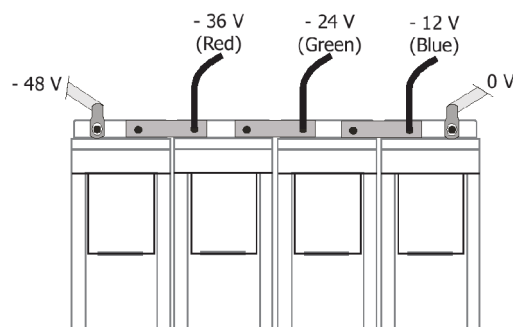

*Figure 4-11 4-Block Symmetry Measurement (for illustration only)*



**NOTE** The interblock Connection Kit is not delivered with the system.



**NOTE** Symmetry cable is normally pre-connected to the system, see Figure 4-7.

### 4.5.7 Temperature Sensor Connection

Temperature Sensor Connection for supervising battery temperature is usually delivered pre-installed when used. On the occasion that it is fitted later it is connected using the three-pin plug according to the same procedure as for the alarm connections.

The sensor itself should be fastened to the battery after battery installation: Unwind the cable, remove the paper covering the adhesive for the sensor and fasten the sensor to the battery as shown in Figure 4-12.

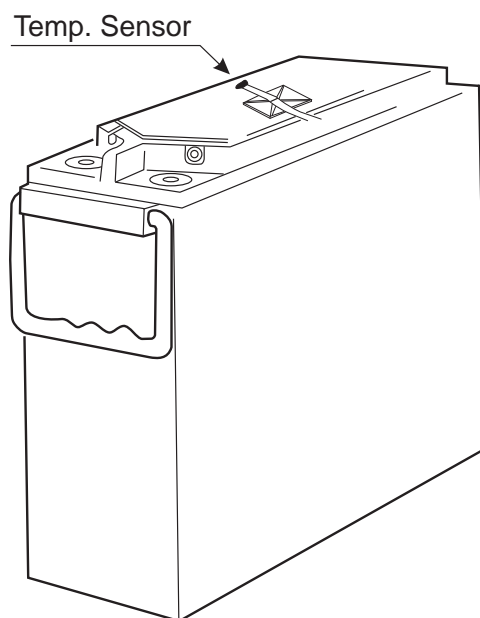

*Figure 4-12 Temperature Sensor Connection*



**NOTE** Temperature sensor is normally pre connected to the system, see Figure 4-8.

---

### 5.1 Commissioning Overview

Before delivery the system was thoroughly inspected and tested. The following chapter is a guide to the set-up and operation of the control functions of the system.



---

**NOTE** Before starting commissioning read the product description for the individual components.

---



---

**WARNING** ONLY TECHNICAL STAFF WITH THE NECESSARY EXPERIENCE AND KNOWLEDGE, WITH REGARD TO THE POWER SUPPLY SUPPORT SYSTEM AND ITS BATTERIES, MAY PERFORM THE COMMISSIONING. IT IS IMPORTANT TO FOLLOW ALL SAFETY REGULATIONS.

---

If there are any difficulties in increasing the voltage to alarm level, the alarm level can be adjusted to a lower level.

### 5.2 Tools and Test Equipment

#### 5.2.1 Tools List

The essential commissioning tools are listed in the Installation chapter.

#### 5.2.2 Test Equipment

- Multimeter (3½ Digit, 0–1% DC)
- Load resistance, to fully load of two rectifiers

### 5.3 Preparation

Check the installation to ensure the following:

- Grounding: The equipment is correctly grounded. The grounding cable size, color and routing conform to the requirements.
- Power: The incoming mains AC power is available for this site. The site power switch and circuit breakers are clearly labeled. The power cables are correctly terminated.
- The site is clean and safe. Check that the system/cabinet is free of any unwanted objects or insects that may have got in during the installation.

## 5.4 Commissioning procedure

1. Remove the covers and check that all connections are made according to the installation drawing. Verify that all connections are properly tightened with sufficient torque.
2. Ensure that load and battery MCB breakers are set to OFF position - ensuring the load and battery strings are connected.
3. Ensure that all rectifier modules are removed. If not, remove each one in turn starting from the rightmost position.
4. If the rectifier subrack has dip switches for addressing, verify that the dip switches are set correctly.
5. Check the battery polarity with the multimeter (3½ Digit, 0.1% dc). Place the positive lead of the meter to the positive busbar and the negative lead to the battery breaker. The meter must now show a positive voltage. If the voltage is negative, change over the connection of the blue and black battery cables to the batteries.
6. Turn on the AC mains voltage.
7. Measure the AC voltage on the AC terminal block between phases and neutral. The correct value is approximately 230V. If the value is different, check the AC connection.
8. Plug in all rectifier modules, starting from the leftmost position. Make sure to fasten the rectifiers again. The rectifiers will turn on automatically.
9. Set all load breakers into the “1” (ON) position.
10. Verify correct polarity on the battery connection by measuring the voltage drop across the battery breaker(s) (Normally not more than 5V DC).
11. The green LED on the controller should blink for approximately 20 sec.
12. The output voltage will increase slowly to U1 (float charge voltage).
13. Turn the battery breaker(s) to the “1” (ON) position.
14. If any alarms are present, they should be reset in accordance with the procedure for the installed controller, ACC or PCC.
15. The system should now be without alarms.
16. Attach all the system covers in their correct places.
17. Check that all changes to drawings, if any, have been completed.
18. Clean the site.
19. Fill in the commissioning record (see end of chapter).

## 5.5 Test of output voltage

### 5.5.1 Float charge (U1)

Ensure that the controller is operating.

Connect a load, approx. 50% of total capacity, to the system.

Check the voltage according to the battery manufacturer's requirements. If the batteries require a different float charging voltage, adjust the output voltage from the controller. (See the section for the appropriate controller)

If no change is required, use the following values:

Battery type	Float charge	Boost charge
Open lead-acid batteries	2.23 V/Cell	2.33 V/Cell
Valve regulated lead-acid batteries	2.27 V/Cell	-

*Table 5-1 Float/Boost Charge Voltages*

### 5.5.2 Adjustment of Float Charge, U1

Unless otherwise ordered the default output voltage is factory pre-set to 53.5V. The total voltage has to be in accordance to the number of battery cells.

Please verify number of cells and the battery manufacturers requirement.

Adjust the output voltage from the control unit as necessary.



**NOTE** A seal protects the potentiometer in the subrack. Do not break the seal.

### 5.5.3 Boost charging (U2) (if applicable)

#### Open lead-acid batteries.

Automatic boost charging - calculation based on the time the battery voltage has been below certain levels. Automatic activating of boost charging for this calculated time multiplied by a (boost) factor.

Activate boost charging from the "Set/select U1-U4" menu in the controller.

Return to float charge manually by selecting "U1", or automatically after a pre-set time.

#### VRLA batteries.

Most of the manufactures of valve regulated lead acid batteries **do not recommend** boost charging. If this type of battery is used, the boost function should be disabled.



## **Boost charging figures**

Observe and write down all of the boost charging figures. Parameters to be read/set/adjusted from control unit or PC with PowCom™ installed.

## **5.6 Battery supervision**

### **For systems with symmetry cables supplied:**

Set the number of battery strings according to the number of battery strings in the system. The settings are to be made in the control unit via a PC with PowCom™ installed or directly in the controller (if symmetry failure is indicated).

The symmetry fault alarm can be simulated by pulling out one symmetry cable from the battery string. Measure that setting to make sure that it is in accordance with the battery manufacturer's recommendations.

### **For systems with temp. probe cable supplied:**

Temperature compensation is factory pre-set. Check that the temp. probe is activated and verify that the compensation level is in accordance with the battery manufacturer's requirements. (If no compensation level is available from the battery manufacture, UNIPOWER recommends that it is set to 0.5V).

## **5.7 Battery test**

Settings should be made according to the battery manufacturer's requirements, but as a rule of thumb the following settings can be used for standard VR lead batteries:

No. of test pr. year	=	2
U3 Test	=	1,9 V/cell
End voltage b.test	=	1,94V/cell
Batt. test time	=	40% of expected backup time
Ah limit for test	=	40% of nominal battery capacity

Parameters should be set/adjusted from the controller (Battery test menu) or "Supervision - Set parameters" menu in PowCom™.

## 5.8 Commissioning record

This is a step-by-step commissioning record for easy commissioning of Power Supply Systems. Do not continue if any faults occur during this commissioning. The checkpoints are to be considered as a minimum for commissioning of the system.

		Checked (✓)	Result
1	Check that the rack is level		
2	Check that all breakers are turned to “off” position and that no rectifiers are mounted in the subrack(s).		
3	Connect AC, and measure voltage on the mains input connections in the cabinet, Is to be 230V AC (Measure 230V from phase to N when 400V mains input is used)		L1-N:.....V AC L2-N:.....V AC L3-N:.....V AC
4	Mount the rest of the rectifiers		
5	After connection of battery, verify right polarity by measuring the voltage drop across the battery breakers (normally not more than 5V DC).		
6	Check float charge, U1, and boost charge, U2. It is to be adjusted according to the battery manufacturers requirements.		U1:.....V DC U2:.....V DC
7	Check temperature compensation. It is to be adjusted according to the battery manufacture requirements.  Check temperature read from the controller compared to the ambient temperature.		Comp.:.....V/10°C Read off:.....°C
8	Check symmetry measurement and set number of battery strings according to actual number of supervised battery strings in the system.		Number: ....  Alarm limit:.....
9	Check alarm transmission by running an alarm test.		

**Table 5-2 Commissioning Record**

## 6.1 Maintenance

Power system maintenance includes maintaining all parts of the system.

Annual maintenance should involve checking all connections on the terminals and circuit breakers. Output voltage should be verified to be within the acceptable limits at least once a year. Test results should be recorded and filed to see any deviations.

The power system requires periodic inspections and routine cleaning. It is very important to keep all areas and components of the system free from dust or other unwanted objects to ensure free air circulation and safe operation of the system.



**CAUTION** To undertake any further maintenance, strictly follow all manufacturer's recommendations provided in the equipment manual.

## 6.2 Troubleshooting

This troubleshooting chapter helps to determine the cause of the problem and suggests possible repair solutions. If the first step of the recommendation does not solve the problem continue to the next one.



**NOTE** If the malfunctioning of the system persists, please contact UNIPOWER technical support.

**NOTE** For a description of Alarms and Messages generated by the system controller see the Alarms/Messages section of the appropriate controller manual:



ACC Extended: <http://www.unipowerco.com/pdf/acc-man.pdf>  
PCC: <http://www.unipowerco.com/pdf/pcc-man.pdf>

By default, alarms are set to be indicated with a red light (higher priority) and messages with a yellow light (lower priority).

Fault	Possible Cause	Suggestion/Solution
<b>Low System Voltage</b>	Module failure.	Replace faulty module.
	Loss of AC power.	Verify AC input connection.
	Load exceeds module capacity.	Add module to system.
<b>High System Voltage</b>	Module failure.	Replace the faulty module.
	System voltage exceeds the set limit.	Check the High Voltage Alarm limit setting.

<b>Fault</b>	<b>Possible Cause</b>	<b>Suggestion/Solution</b>
<b>Mains Error</b>	AC supply OFF on one rectifier in the system with one plugged in rectifier.  AC supply OFF on at least two rectifiers in the system with minimum two plugged in rectifiers.	Verify that the AC input breaker is ON.  Verify AC input connection.
<b>AC Low Voltage</b>	AC voltage drops below the set limit.	Verify the Low AC voltage limit setting.  Verify AC Input connection.  Verify AC Input voltage.
<b>AC High Voltage</b>	AC voltage rises above the set limit.	Verify the High AC voltage limit.  Verify the AC Input voltage.
<b>Module Failure</b>	Faulty module.  AC OFF on a single rectifier (if more than one rectifier is installed).  Rectifier current sharing fault.  Low DC output voltage, overvoltage shutdown, module fan failure, module is overheated.	Check if module sends alarm flag.  Verify the AC voltage to the failed module.  Re-insert the faulty module, wait for 30 seconds  Replace the faulty module.
<b>Urgent Module Failure</b>	More than one rectifier is reporting Module failure.	See Module failure alarm.
<b>High Load</b>	Faulty module .  Rectifier load current exceeds the set High load limit [%].	Compare the load current with installed rectifier capacity.  Add a rectifier or reduce load.  Verify the High load limit setting.  Replace the faulty module.
<b>Overvoltage Shutdown</b>	Faulty module	Re-insert the module, wait for 5 minutes.  Replace the faulty module.
<b>Load/Battery Disconnection</b>	System voltage drops below the set limit.  System shutdown.	Check the battery condition.  Check the AC mains connection.  Check the input breaker.  Check the rectifier modules.

<b>Fault</b>	<b>Possible Cause</b>	<b>Suggestion/Solution</b>
<b>Communication Failure</b>	<p>Module failure.</p> <p>Modules not installed in the correct position.</p> <p>Broken or disconnected communication wire.</p>	<p>Check the non-communicating address</p> <p>If the rectifier address does not communicate re-install the module and wait for 5 minutes.</p> <p>Verify that the communication cable is properly connected and it is not damaged. Replace if necessary.</p> <p>If the board address does not communicate, check if it is installed in the system. If it is, replace the board.</p> <p>If there is a non-communicating module or unit, remove the non-communicating address from the controller (Accept removed parts). Do so only if you are sure you do not use them any more.</p> <p>Verify, if the controller is operating properly. If not, replace the controller.</p>
<b>Distribution Fuse Failure</b>	Tripped load breaker / blown load fuse.	<p>Verify there is no short circuit in load cabling.</p> <p>Reset the breaker, if it trips again, there is a problem with the load or a breaker itself.</p> <p>Replace the breaker / fuse if necessary.</p>
<b>Battery Fuse Failure</b>	Tripped load breaker / blown load fuse	<p>Verify there is no short circuit in load or battery cabling.</p> <p>Verify the breaker / fuse is correctly rated.</p> <p>Reset the breaker, if it trips again, there is a problem with the load or battery or a breaker itself.</p> <p>Replace the breaker / fuse if necessary.</p>

<b>Fault</b>	<b>Possible Cause</b>	<b>Suggestion/Solution</b>
<b>Symmetry Fault</b>	Battery at end of life.  Wrong symmetry cable connection.  Wrongly set Symmetry limit value.	Verify the battery condition.  Verify the symmetry cable connection.  Verify the Symmetry limit value.
<b>Low Battery Temperature</b>	Battery temperature drops below the set Low battery temperature limit.	Check the heating of the system.  Check the ambient temperature (it should not be lower than recommended battery temperature).
<b>high Battery Temperature</b>	Battery temperature exceeded the set limit.	Check the cooling or ventilation.  Verify the battery condition.  Check the Battery Current Limit.
<b>Temp. Probe Failure</b>	The temperature probe is not properly connected to the system.  Faulty temperature probe.  Temperature probe wire is interrupted.  Temperature difference between the controller temperature and the probe temperature is greater than 60°C.	Verify the temperature probe connection.  Verify the internal / external temperature via controller front panel.  Replace the faulty probe with a new one.  Identify the root cause of the hot environment at the batteries and/or controller.
<b>Alarms Blocked (only with LCD display)</b>	Alarm is manually activated by the serviceman on the site (used during system servicing, no other alarm is displayed)	Needs to be manually turned OFF to allow the alarms to be displayed

If none of the above solves the problem please contact customer support.

To phone us please visit <http://www.unipowerco.com/contact/> and select Customer “Support/ Repairs” and then “Customer Service” where you will find the correct phone number for your region.

Alternatively, email: [sales@unipowerco.com](mailto:sales@unipowerco.com)

### 7.1 Controller Replacement

A faulty Controller can be easily replaced with a new one:

1. Loosen the front screw in the top left corner of the controller front panel using a flat screwdriver and then pull the controller out of the shelf, see Figure 7-1.

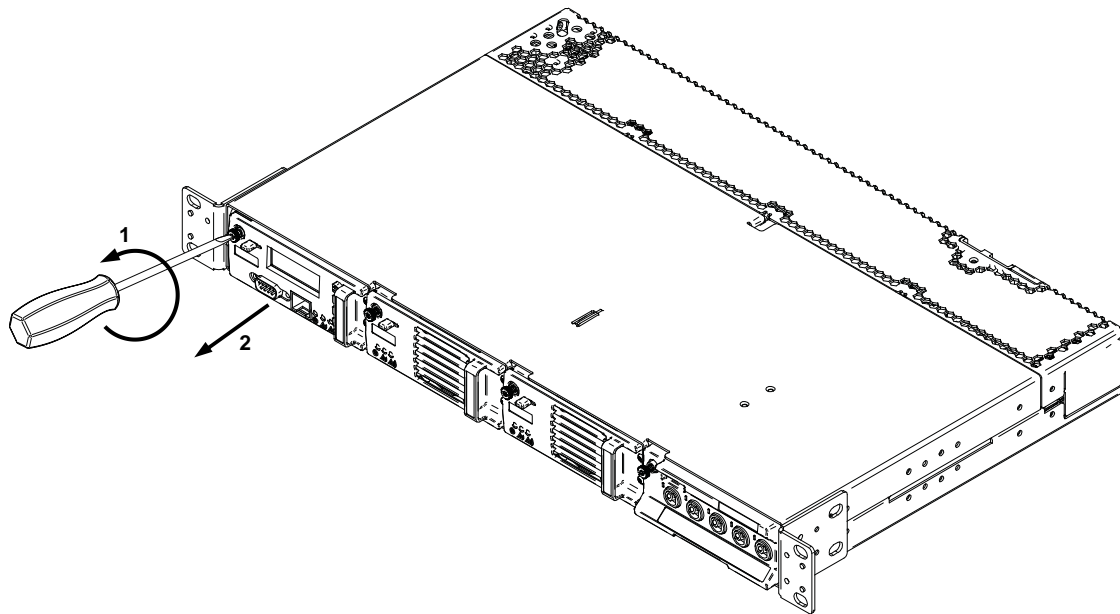

*Figure 7-1 Unlocking and removing the Controller*

2. Reverse the process to insert the new controller into the empty slot and fasten the screw.



**CAUTION** After controller start-up, verify if the appropriate configuration file is uploaded to the controller. If necessary refer to the [PowCom™ User Guide](#).

## 7.2 Rectifier Replacement



**NOTE** Rectifiers can be hot-swapped.

### 7.2.1 XR04.48 / XR08.48 Replacement

To replace an XR04.48 or XR08.48 rectifier, follow the same procedure as for the controller.

### 7.2.2 XPGe12.48 Replacement

1. Insert a flat screwdriver into the rectangular opening next to the left handle to unlock it, Figure 7-2 (1).
2. Once unlocked, pull both handles down and remove the rectifier from the slot, Figure 7-2 (2).
3. Replace rectifier. Make sure that the rectifier handle is in OPEN position (forms 35-40° angle with rectifier body) before XPGe12.48 is fully inserted in the slot.
4. Push both handles upwards until the left handle locks the rectifier into the correct position.

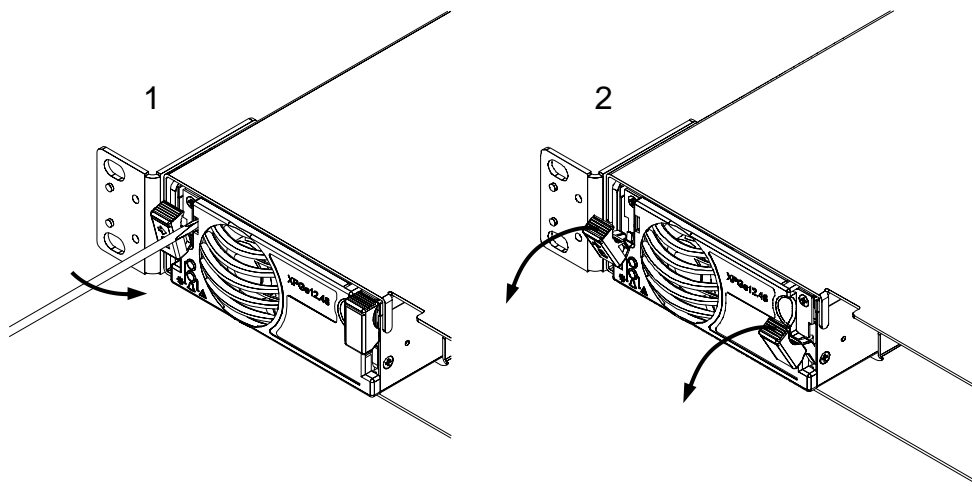

*Figure 7-2 Replacing an XPGe12.48 Rectifier*



**CAUTION** After rectifier rebooting, check that the green LED is lit.



## 7.3 Breaker Replacement



**WARNING** Make sure the system is switched OFF.

To replace a faulty circuit breaker, follow the steps below, see figure 7-3:

1. Remove the breaker front cover.
2. First apply a spanner to the breaker fastening nut at the front (2a) then loosen the breaker (2b). Unplug the breaker and remove it (2c).
3. Insert the replacement breaker in the vacant slot (3a), apply the fastening nut (3b) and fasten it (3c).

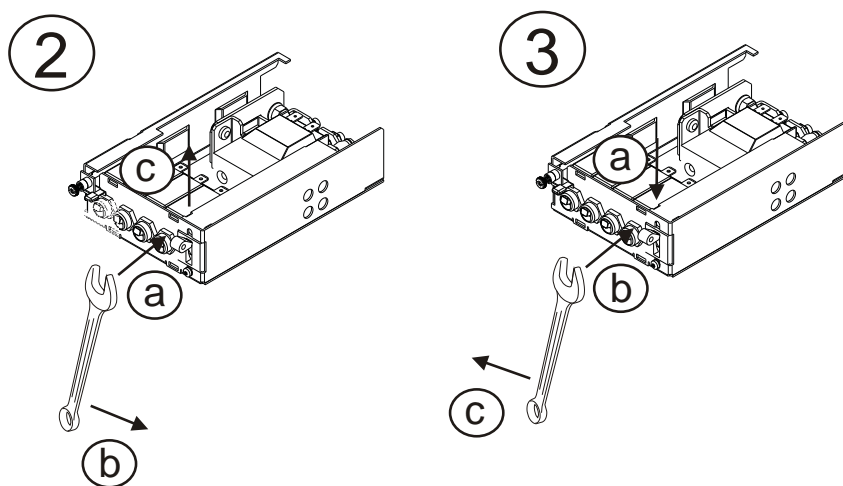

**Figure 7-5 Breaker Replacement**

*This document is believed to be correct at time of publication and UNIPOWER LLC accepts no responsibility for consequences from printing errors or inaccuracies. Specifications are subject to change without notice.*

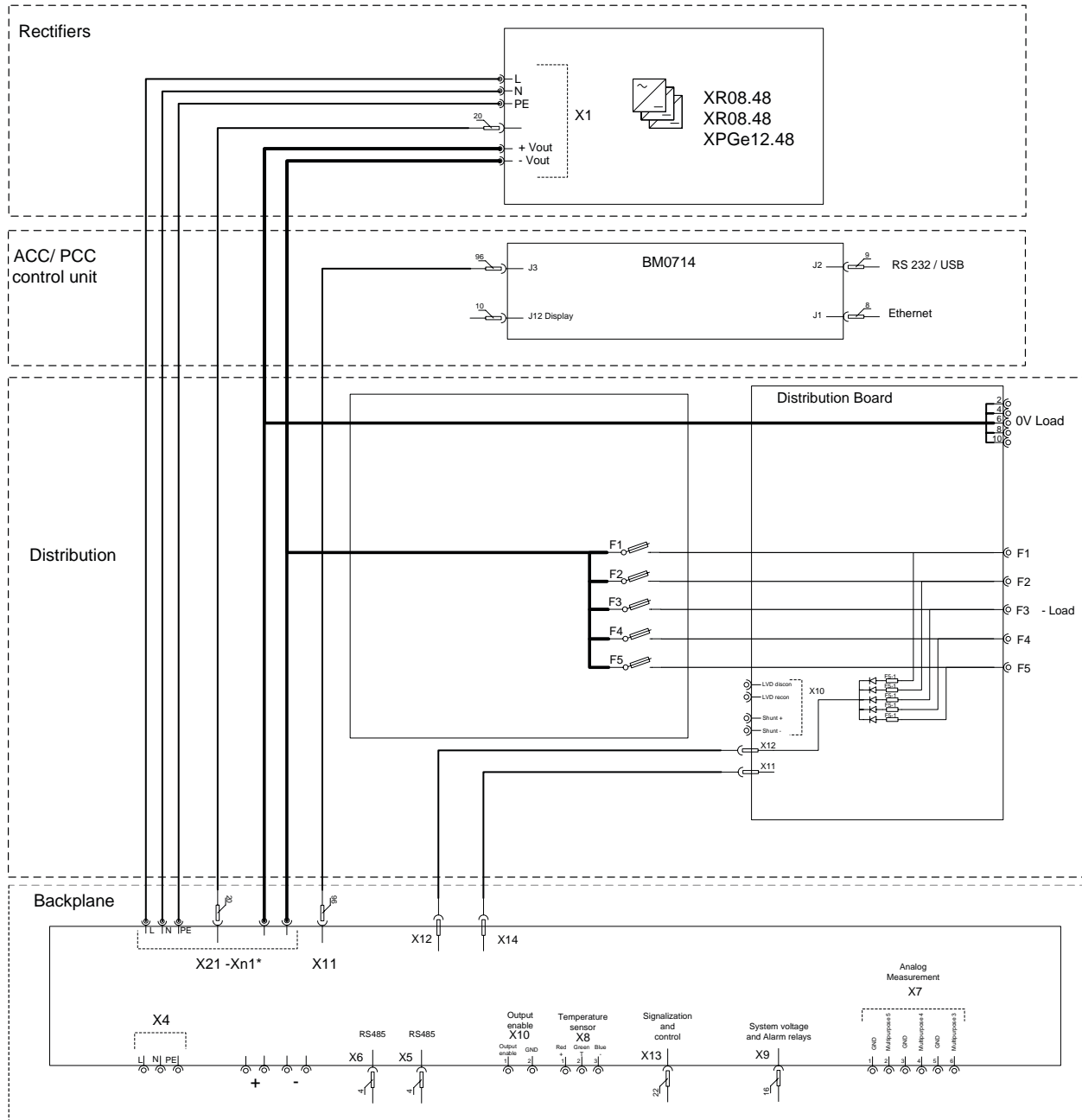

Configuration with 5 x load breakers shown





LVD2006/95/EC  
ROHS2011/65/EU



## Features

- 1U height solution
- Wide AC input: 85 to 300VAC
- Wide operating temperature range: -40°C to +75°C
- Ethernet interface
- Simple installation
- Designed for 300mm deep ETSI cabinets
- Rear Side cable connection
- Various fuse options
- International standards compliance



**XPGe12.48 Rectifier**



**ACC Extended Controller**

## Description

Aspiro DC power system offer a range of solutions for diverse applications such as broadband access, cable head ends, micro/pico BTS Cells, Enterprise E911, and GSM-R.

Aspiro uses highly-efficient, dense, and reliable XR04.48 / XR08.48 or XPGe12.48 rectifier modules and is highly adaptable to provide a complete solution for today's global applications. System management is accomplished via a pluggable system controller, complete with remote accessing functionality with an Ether-net, web server, and SNMP interface.

Highly flexible distribution options offer the optimum 1U shelf solution for space-critical applications. In addition, installation within compact environments is made simple and includes reduced-depth distribution shelves catering for rear side cable connection.

## Technical Data

### Output

Voltage	-48VDC
Rectifier Types	XR04.48 (9.1A   400W), XR08.48 (18.2A   800W) or XPGe12.48 (22.6A   1200W)

### DC Distribution

Battery Breakers	1 maximum
Load Breakers	4 maximum

### AC Input

Voltage (rectifier)	85-300VAC (XR04.48/XR08.48) or 90-300VAC (XPGe12.48)
Frequency	47-63Hz
Connections	1x or 2x 230 VAC (Single Phase)
Input Current	<8A per rectifier
Power Factor	>0.98 typical

### Monitoring & Control

Controller	PCC or ACC Extended
Alarm Relays	4 x Potential free alarm relays (C, NC, NO)
Local Interface	4 x 20 LCD, 4 key menu, USB*/RS232
Remote Interface	Ethernet/Modem using PowCom™ software package
Visual Indication	Green LED – System ON, Yellow LED – Message(s), Red LED – Alarm(s)
External I/O	12 multi purpose analogue (0-100V), 2 x digital inputs, 1 x digital output

### Battery Management

Symmetry Inputs	Max. 3
Programmable LVD	Yes
Temperature Compensation	Yes

### Connections

Battery	Battery Cable, M6 lugs
Input	Stripped cable with ferule, max. 4mm <sup>2</sup>
Load	Stripped cable with ferule, max. 4mm <sup>2</sup>
Alarms	Stripped cable with ferule, max. 1.5mm <sup>2</sup>

### Compliance

EMC	ETSI EN 300 386 V.1.3.2 ; EN 61000-6-3 (Emission) ; EN 61000-6-2 (Immunity)
Safety	EN 60950-1

### Environmental

Operating Temperature	-40°C to +75°C, derating over 55°C
Storage Temperature	-40°C to +85°C

### Mechanical

Dimensions	483mm W, 44.45mm H, 280mm D
Weight	4.85kg
Mounting Options	19" / ETSI / Mid-mount

\* ACC only

## System Description

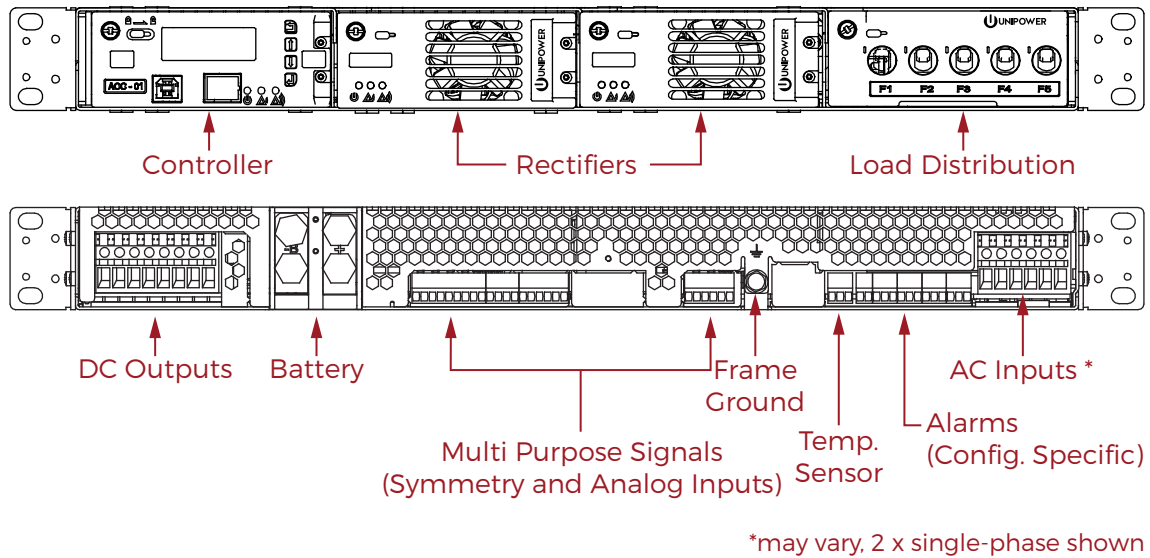

## Outline Dimensions

